



ESTS SCHOOL



ERS

**ESTS
SCHOOL OF
THORACIC
SURGERY**

FIRST **ESTS-ERS** COLLABORATIVE COURSE ON THORACIC ONCOLOGY A MULTIDISCIPLINARY UPDATE ON POTENTIALLY OPERABLE LUNG CANCER

11-13 February 2019

Johnson & Johnson Institute, Hamburg, Germany



Application will be made for accreditation
to European Accreditation Council for Continuing
Medical Education (EACCME®)

Organisers: Gilbert Massard, Strasbourg, France
Bogdan Grigoriu, Brussels, Belgium

INFORMATION & REGISTRATION: www.ests.org

FACULTY



Gilbert Massard, Strasbourg, France
ESTS President & ERS Programmes Director



Bogdan Grigoriu, Brussels, Belgium
ERS Thoracic Oncology Assembly Secretary (2015-2018)



A MULTIDISCIPLINARY UPDATE ON POTENTIALLY OPERABLE LUNG CANCER

11-13 February 2019 · Johnson & Johnson Institute, Hamburg, Germany



DAY 1: 11 FEBRUARY 2019

DIAGNOSTIC PATHWAYS AND WORK-UP

13.00-13.30	WELCOME SESSION Presentation round Educational offer of ESTS and ERS	16.00-16.30	Coffee break
13.30-14.00	SCREENING: WHERE DO WE STAND 6 YEARS AFTER THE "BIG TRIAL"?	16.30-17.30	WORKSHOPS Workshop 1: staging issues Workshop 2: evaluation of fitness (lung, heart, comorbidities)
14.00-15.00	CLASSIFICATION OF LUNG CANCER Adenocarcinoma: correlation with imaging and prognosis: Neuro-endocrine carcinomas Revision of TNM: precision or confusion?	17.30-18.30	WORKSHOPS (continued)
15.00-16.00	NEW DIAGNOSTIC TOOLS Endoscopy: autofluorescence, EBUS, EBN Liquid biopsy Biomarkers and implications How much tissue is required?	18.30	Transfer to the hotel, evening free

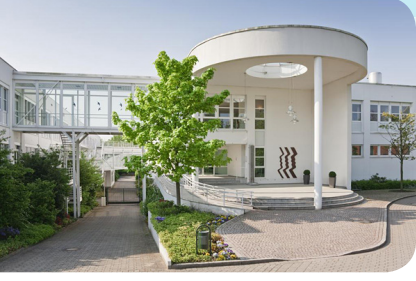

A MULTIDISCIPLINARY UPDATE ON POTENTIALLY OPERABLE LUNG CANCER

11-13 February 2019 · Johnson & Johnson Institute, Hamburg, Germany



DAY 2: 12 FEBRUARY 2019

EARLY STAGE LUNG CANCER

8.30-9.30 **WHICH TYPE OF RESECTION ?**

- Advantages of VATS for lobectomy
- When is sublobar resection justified
- Saving parenchyma with bronchial and/or arterial sleeve lobectomy

9.30-10.30 **ALTERNATIVE TREATMENTS**

- SABR
- Thermoablation
- Is surgery still better ?

10.30-11.00 Coffee break

11.00-12.00 **SURGERY FOR EARLY STAGE SMALL-CELL LUNG CANCER ? PRO - CON**

12.00-13.30 Lunch

LOCALLY ADVANCED LUNG CANCER

13.30-14.30 **PERIOPERATIVE TREATMENTS**

- Neoadjuvant chemo or adjuvant ?
- Indications and limitations of radiation therapy

14.30-15.30 **SURGERY FOR ADVANCED DISEASE**

- Extended resections
- Oligometastatic disease

15.30-16.00 Coffee break

16.00-17.00 **WORKSHOPS**

- Workshop 3: MDT pulmonary nodule and GGO

- Workshop 4: MDT locally advanced tumour

17.00-18.00 **WORKSHOPS** (continued)

18.00 Transfer to the hotel
Dinner



A MULTIDISCIPLINARY UPDATE ON POTENTIALLY OPERABLE LUNG CANCER

11-13 February 2019 · Johnson & Johnson Institute, Hamburg, Germany



DAY 3: 13 FEBRUARY 2019

8.30-9.30

COMPLEX SITUATIONS

Surgery in the context of ischemic heart disease

Oligo-progressive disease

Salvage surgery

9.30-10.30

INNOVATIVE TREATMENTS

State of the art of targeted therapies

Immunotherapy

10.30-11.00

Coffee break

11.00-12.00

PATIENT SAFETY AND QUALITY OF LIFE

Applied to surgery

Applied to medical therapies

Applied to radiation therapy

12.00-13.30

EVALUATION AND CONCLUSION

13.30

Transfer to the airport

